

OVERALL DIMENSIONS

外型尺寸

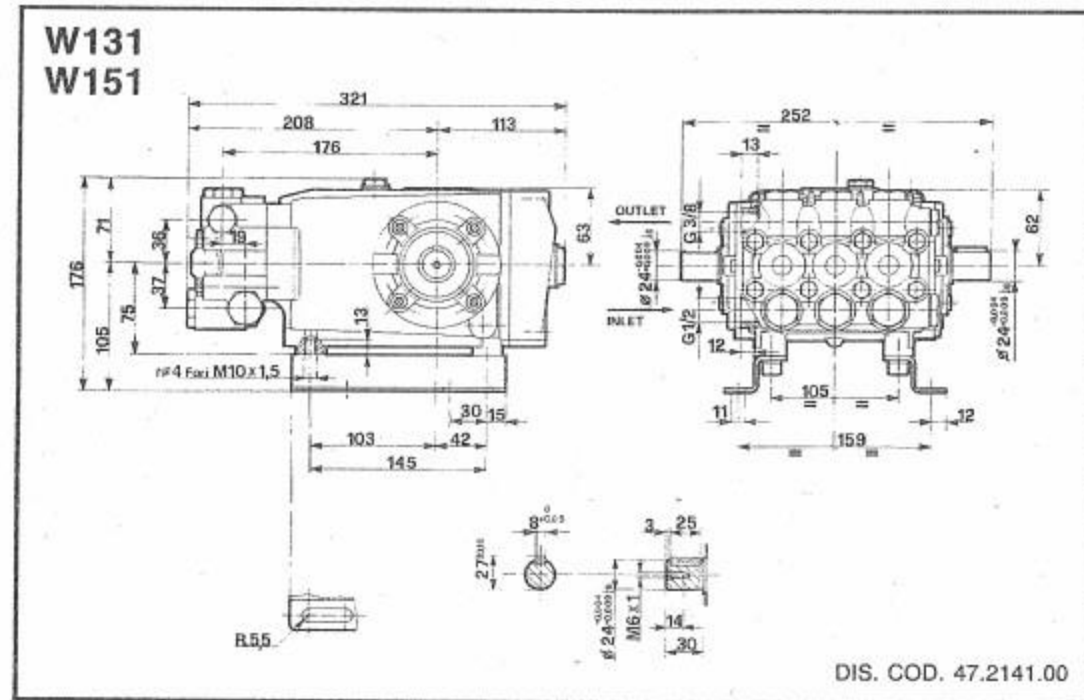

REVISIONE N. 3

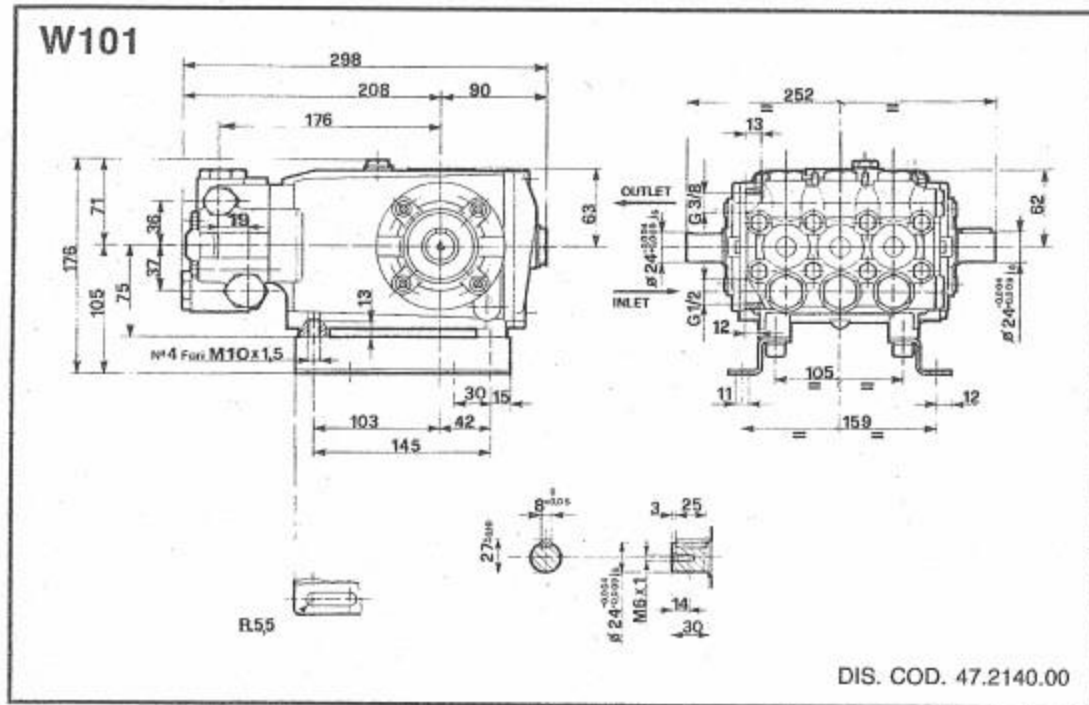

PUMP W101 - W131 - W151



<p>■ LUBRICATION: We recommend INTERPUMP OIL X-9.9. (SAE 15W40 Mineral) - OIL CAPACITY</p> <p>润滑: 我们建议您使用INTERPUMP OIL-9.9 (SAE 15W40) 加油量为</p>	W101	W131 W151
	1	1,2
	1	1,2

Cod. 47.2242.03 - 01/07 - 1.000 DePietri

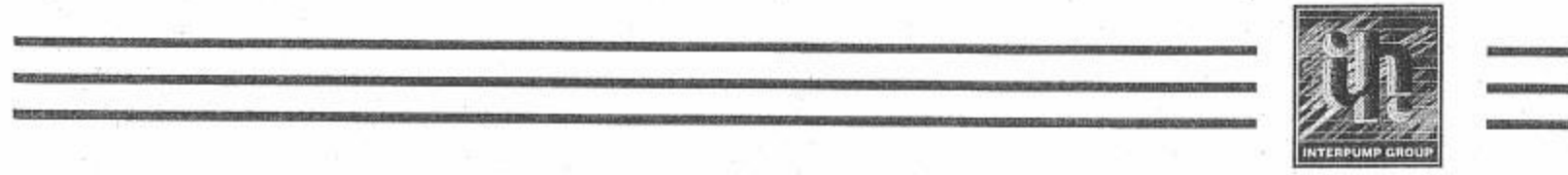

pump type 泵型号	volume 流量		pressure 压力		r.p.m. 转速	required 输入功率		weight kg. 重量	overall dimensions 外型尺寸
	l/min	G.P.M. (USA)	bar	p.s.i.		hp	kw		
W101	15	3.96	100	1450	1000	4	2,94	14	298 x 252 x 176
W131	15	3.96	130	1885	1000	5,5	4,04	14,5	321 x 252 x 176
W151	15	3.96	150	2175	1000	5,5	4,04	14,5	321 x 252 x 176

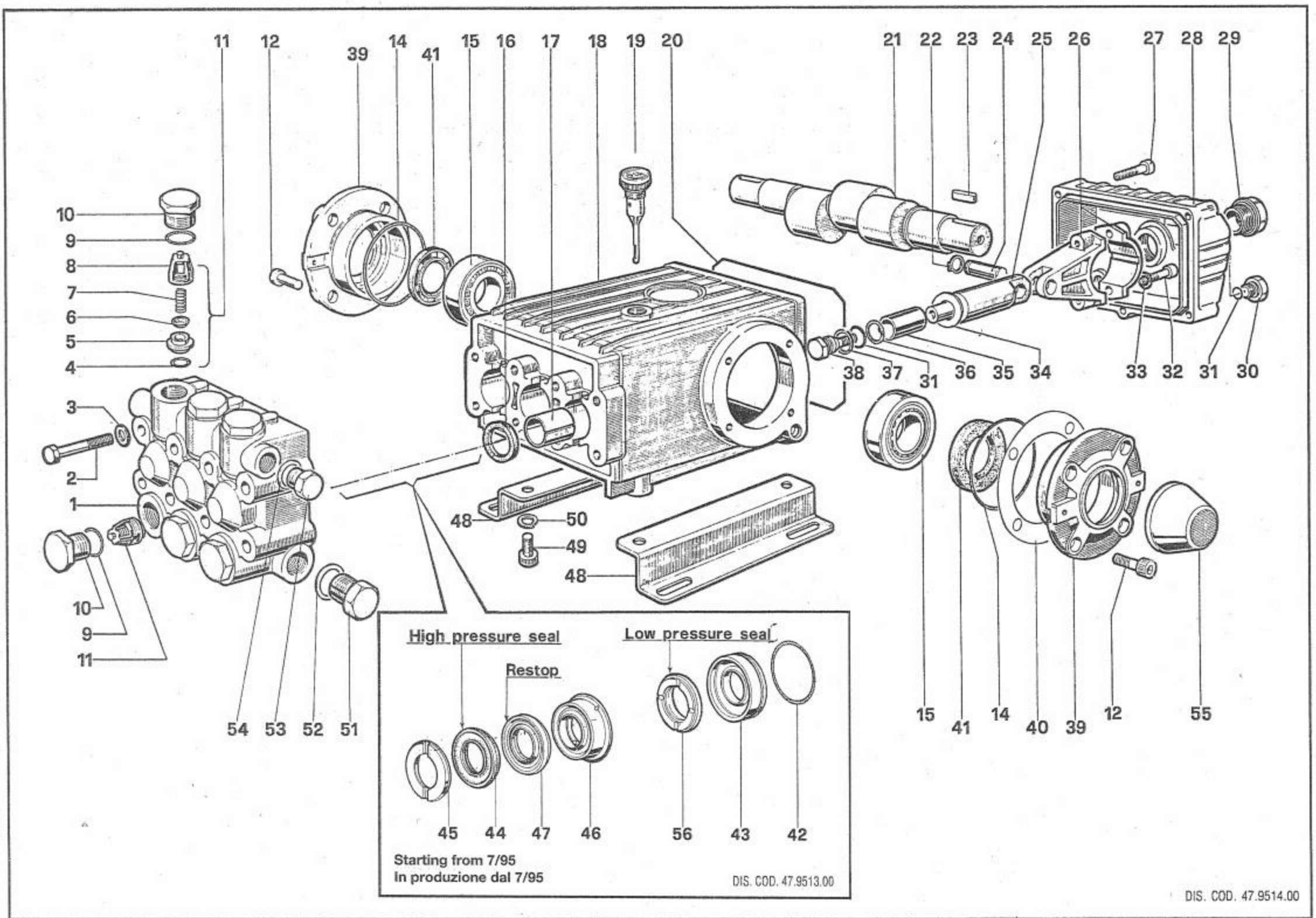

KIT N.	KIT 1	KIT 2	KIT 3	KIT 4	KIT 6	KIT 7	KIT 69	KIT 71	KIT 10	KIT 28
Positions Included	4-5-6-7 8-(11)	16	41	9-10	31-34-36 37-38	45	44-47 56	46-47	42-43	42-43 44-45 46-47 56
包含										
N. pcs.	6	3	2	6	3	6	3	3	3	1

POS.	CODE	DESCRIPTION	说明	N. PCS.
1	47.1201.41	Testata - ØT58 - Brass	铸造黄铜ØT58	1
2	99.3206.00	Vite M8x70 UNI 5737	螺栓	8
3	96.7020.00	Rosetta Ø 8 UNI 1736	垫圈	8
4	90.3841.00	OR Ø 17,13x2,62	o型圈	KIT 1 6
5	36.2003.66	Sede valvola	阀座	KIT 1 6
6	36.2001.76	Valvola	阀	KIT 1 6
7	94.7376.00	Molla Ø 9,4x14,8	弹簧	KIT 1 6
8	36.2002.51	Guida valvola	阀单元	KIT 1 6
9	90.3847.00	OR Ø 20,24x2,62	o型圈	KIT 4 6
10	98.2220.00	Tappo M 24x2x16	螺丝	KIT 4 6
11	36.7032.01	Gruppo valvola	阀单元	KIT 1 6
12	99.3039.00	Vite M8x16 UNI 5931	螺栓	8
14	90.3913.00	OR Ø 67,95x2,62	o型圈	2
15	91.8375.00	Cuscinetto a rulli 32206	滚子轴承	2
16	90.1625.00	Anello radiale Ø 22x32x5,5	油封	KIT 2 3
17	90.9126.00	Boccola Ø 22x25x30	衬套	3
18	47.0100.22	Carter	曲轴箱盖	1
19	98.2106.00	Tappo carico olio G 3/8	油标螺丝	1
20	90.3922.00	OR Ø 133,02x2,62	o型圈	1
21	47.0200.35	Albero - Doppio P. di F. W101	曲轴	1
	47.0211.35	Albero - Doppio P. di F. W131		1
	47.0201.35	Albero - Doppio P. di F. W151		1
22	90.0557.00	Anello di fermo	密封环	6
23	91.4878.00	Linguetta	键	1
24	97.7380.00	Spinotto Ø 13x35	销子	3
25	47.0504.54	Guida pistone W101	曲轴	3
	47.0505.54	Guida pistone W131 - W151		3
26	47.0300.01	Biella completa	连杆	3
27	99.1837.00	Vite M6x14 UNI 5931 (W101)	螺栓	5
	99.1912.00	Vite M6x30 UNI 5931 (W131-W151)		5
28	47.1600.22	Coperchio carter W101		1
	47.1601.22	Coperchio carter W131-151	曲轴箱端盖	1

POS.	CODE	DESCRIPTION	说明	N. PCS.
29	97.5968.00	Spia olio G 3/4	油标螺丝	1
30	98.2041.00	Tappo G 1/4x9	螺丝	1
31	90.3585.00	OR Ø 10,82x1,78	o型圈	KIT 6 4
32	99.3099.00	Vite M8x35 UNI 5931	螺栓	6
33	96.7014.00	Rosetta Ø 8,4x13x0,8	垫圈	6
34	96.7286.00	Rosetta Ø 14x28x0,5	垫圈	KIT 6 3
35	47.0404.09	Pistone Ø 20	柱塞	3
36	90.5067.00	Anello per OR	密封环	KIT 6 3
37	96.7280.00	Rosetta Ø 14x18,5x0,5	垫圈	KIT 6 3
38	47.2195.66	Vite fissaggio pistone	螺栓	KIT 6 3
39	47.1500.22	Coperchio carter	曲轴箱盖	2
40	97.5678.00	Spessore	薄片	2
41	90.1648.00	Anello radiale Ø 30x55x7	油封	KIT 3 2
42	90.3616.00	OR Ø 34,65x1,78	o型圈	KIT 10-28 3
43	47.0805.70	Anello di fondo Ø 20	密封环	KIT 10-28 3
44	90.2705.00	Anello tenuta Ø 20 H.P. seal	高压密封环	KIT 28-69 3
45	47.1000.51	Anello testa Ø 20	第一环	KIT 7-28 3
46	47.2169.70	Anello intermedio Ø 20	中间环	KIT 28-71 3
47	90.2704.00	Anello "RESTOP" Ø 20	限位环	KIT 28-69-71 3
48	47.2000.74	Piedino	底脚	2
49	99.3644.00	Vite M10x18 UNI 5931	螺栓	4
50	96.7106.00	Rosetta Ø 10 DIN 7980	垫圈	4
51	98.2176.00	Tappo G 1/2x10	螺丝	1
52	96.7514.00	Rosetta Ø 21,5x27x1,5	垫圈	1
53	98.2100.00	Tappo G 3/8x13	螺丝	1
54	96.7380.00	Rosetta Ø 17,5x23x1,5	垫圈	1
55	47.2124.51	Cappello P. di F.	圆头螺帽	1
56	90.2710.00	Anello tenuta Ø 20 L.P. seal	低压密封环	KIT 28-69 3